

ROSEVILLE 048-280-035
NORMAN DEA 0

SHADE CALCULATION TABLE

TREE-SYMBOL	Count	PERCENT-SHADE	SHADE-AREA	
PIS-CHI	1	25%	157	
PIS-CHI	3	50%	354	1062
QUE-WIS	6	100%	462	5172
QUE-WIS	6	25%	240	1420
QUE-WIS	4	50%	481	1424
ULM-TRU	4	50%	481	1424
			TOTAL	12,754
Total Paved Area		21,935 sf.		
Shade Required 50%		10,967 sf.		
Shade Provided - Trees		12,754 sf.		
Percent Shade		58%		

PLANT SCHEDULE

TREES		CODE	BOTANICAL NAME / COMMON NAME	SIZE	H X W	Very Low	Low	Medium	High	
		PIS CHI	Pistacia chinensis / Chinese Pistache	15 gal	6'0"x35'		X			
		PRU VES	Prunus cerasifera 'Krauter Vesuvius' / Purple Leaf Plum	15 gal	15'x15'				X	
		PRU CHA	Pyrus calleryana 'Chanticleer' / Chanticleer Pear	15 gal	4'0"x15'				X	
		QUE WIS	Quercus wislizenii / Interior Live Oak	15 gal	6'0"x35'	X				
		ULM TRU	Ulmus parvifolia 'True Green' / True Green Elm	15 gal	6'0"x35'		X			
SHRUBS		CODE	BOTANICAL NAME / COMMON NAME	SIZE	H X W	Very Low	Low	Medium	High	
		ARC HOW	Arctostaphylos densiflora 'Howard McMinn' / Howard McMinn Manzanita	5 gal	6'x6'		X	X		
		BUD DAV	Buddleja davidii / Summer Lilac	5 gal	6'x6'			X		
		CAL ARU	Calamagrostis arundinacea 'Karl Foerster' / Foerster's Feather Grass	5 gal	4'x3'			X		
		CAL LIT	Callistemon citrinus 'Little John' / Dwarf Bottle Brush	5 gal	6'x4'		X			
		CIS PUR	Cistus x purpureus / Orchid Rockrose	5 gal	4'x5'		X			
		DIE IRI	Diets iridioides / Fortnight Lily	5 gal	3'x3'		X			
		KNI UVA	Kniphofia uvaria / Red Hot Poker	1 gal	2'x3'		X			
		LAV TRE	Lavatera maritima / Tree mallow	5 gal	6'x6'		X			
		MUH CAP	Muhlenbergia capillaris / Pink Muhly	5 gal	4'x4'		X			
		MYR COM	Myrtus communis / Myrtle	5 gal	5'x5'		X			
		NAN HAR	Nandina domestica 'Harbour Dwarf' / Dwarf Heavenly Bamboo	5 gal	2'x2'		X			
		PER ATR	Perovskia atriplicifolia / Russian Sage	1 gal	2'x4'		X			
		PHO ATR	Phormium tenax 'Atropurpureum' / Purple New Zealand Flax	5 gal	6'x6'		X			
		PHO BRO	Phormium tenax 'Bronze Baby' / Bronze Baby New Zealand Flax	1 gal	3'x3'		X			
		ROS OFF	Rosmarinus officinalis 'Collingwood Ingram' / Rosemary	5 gal	2'x4'		X			
		SAL SAL	Salvia greggii 'Furman's Red' / Furman's Red Salvia	1 gal	3'x3'		X			
GROUND COVERS		CODE	BOTANICAL NAME / COMMON NAME	SIZE	H X W	SPACING	Very Low	Low	Medium	High
		ACA LOW	Acacia redolens 'Lowboy' / Bank Catclaw	1 gal	2'x8'	72" o.c.		X		
		BAC PIL	Baccharis pilularis / Dwarf Coyote Brush	1 gal	1.5'x4'	30" o.c.		X		
		CIS PRO	Cistus salvifolius 'Prostratus' / Sageleaf Rockrose	1 gal	2'x6'	48" o.c.		X		
		CON MAU	Convolvulus mauritanicus / Morning Glory	1 gal	1'x3'	36" o.c.		X		
		COT BEA	Cotoneaster dammeri 'Coral Beauty' / Bearberry Cotoneaster	1 gal	5'x8'	48" o.c.		X		
		ROS COL	Rosmarinus officinalis 'Collingwood Ingram' / Rosemary	1 gal	2'x4'	12" o.c.		X		
		TUR SOD	Turf Sod / To Match Existing	sod						X
		TUR MOW	Turf Sod Mow Free Fescue Blend / Drought Tolerant Fescue Blend	sod					X	
		VIN MIN	Vinca minor / Common Periwinkle	1 gal	5'x2'	24" o.c.			X	

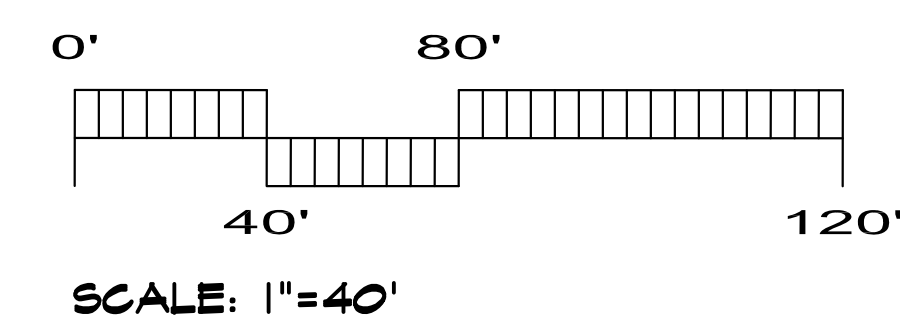
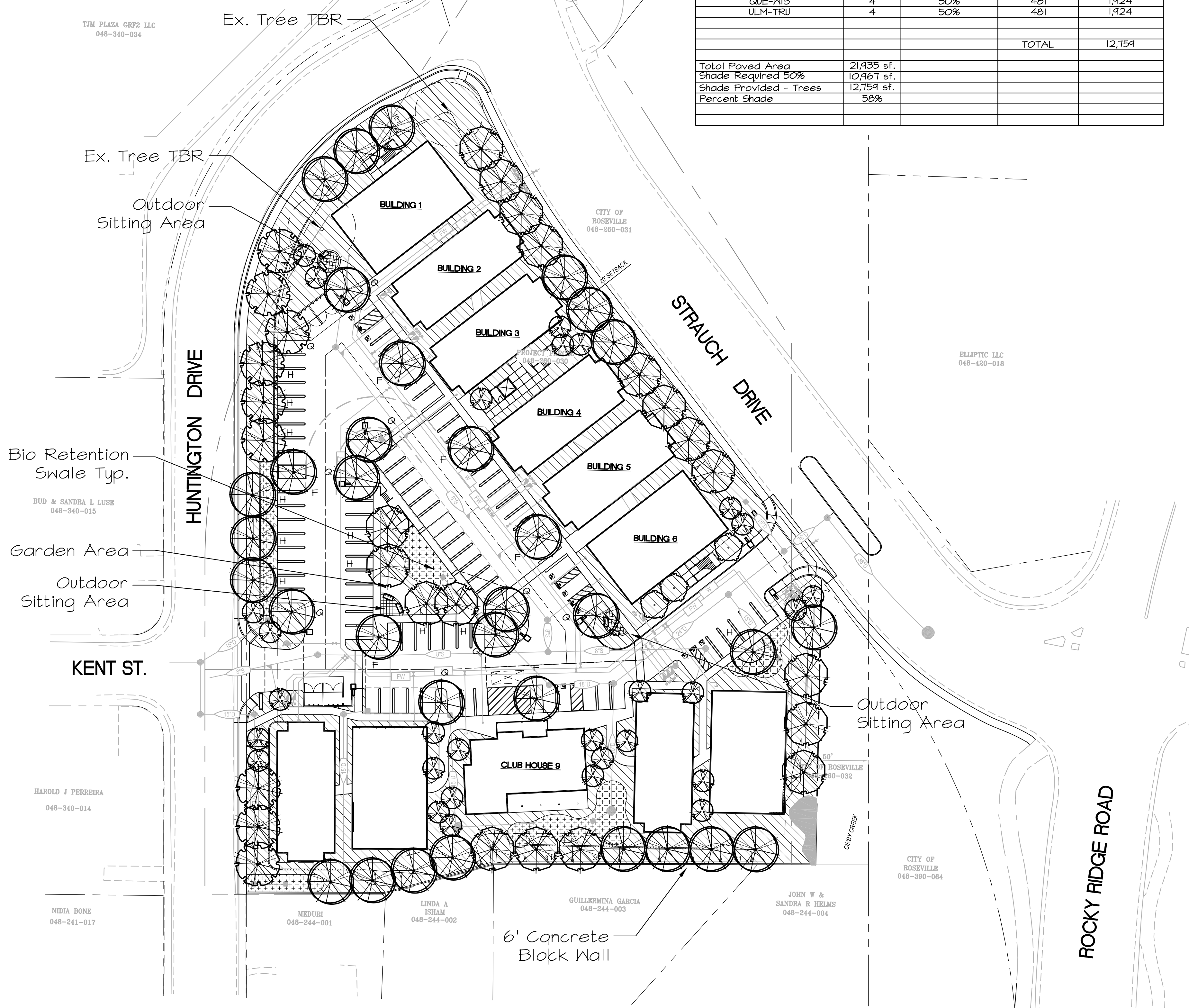

YAMASAKI
LANDSCAPE ARCHITECTURE
1223 HIGH STREET, AUBURN, CA 95603
(530) 885-0040
FAX (530) 885-0042

HUNTINGTON SENIOR APARTMENTS
for ICON ENTERPRISES - HUNTINGTON PLACE
1650 HUNTINGTON DRIVE
ROSEVILLE, CALIFORNIA

PRELIMINARY LANDSCAPE PLAN

April 9, 2018

craig MIERS + **george SCOTT**
ARCHITECTS llp

5204 Santa Clara Drive, Suite 100
Roseville, CA 95608
916.780.0000
916.780.0007 mobile
916.780.0001 fax
craig@cmierscottllp.com